

P.O. Box 1048
Turks & Caicos Islands.
B.W.I.
FAX: (649) 941-5996
PHONE: (649) 946-4420
AFTN: MBPVYOYX
Email: ais@tciairports.com
Web: www.tciairports.com

**TURKS & CAICOS ISLANDS
AIRPORTS AUTHORITY**
Aeronautical Information Services
AERONAUTICAL INFORMATION CIRCULAR

**AIC
01/2011
2 May 2011**

New Apron and Taxiway at Providenciales Airport

The Providenciales International Airport is undergoing a major redevelopment and expansion phase. The aim of the project is to satisfy aviation demand and resolve present and future aviation, environmental and socioeconomic issues. The work commenced in June 2010 with completion expected in July 2011.

The completed expansion will see the increase in length of Runway 10-28 by 1,600ft (487.68m) for a total available runway length of 9,200ft (2,804.16m). Figure 1 illustrates.

The planned expansion of the existing apron will see an additional space of approximately 37,000 m² with a third connecting taxiway (Taxiway Golf) to provide access to Runway 10-28.

Rehabilitation of the existing pavement facilities on Runway 10-28, Taxiways Alpha, Bravo and the Apron, including airfield electrical replacement of Taxiway A, B and Runway 10-28 will also be completed. These expansions will provide significantly greater flexibility and functionality for airport operations.

In summary, the work proposed for 2010/11 includes:

1. Rehabilitation and Extension of Runway 10-28, including OLS Improvements;
2. Construction of a Connecting Taxiway (Golf);
3. Rehabilitation of Taxiways Alpha and Bravo;
4. Rehabilitation and Expansion of the Existing Apron;
5. Upgrades to Existing Airfield Lighting Systems and Controls to Accommodate Runway Extension;
6. Replacement of Taxiway Alpha, Bravo and Runway 10-28 Edgelighting;
7. New Runway Extension/Apron Expansion Edgelighting (incl. floodlighting);
8. Surface Drainage (ditching) Improvements;
9. Installation of New Security Fencing and Gates;
10. Pavement line markings;
11. 240m RESA installation on both Runway 10 and 28 ends; and

The newly expanded apron and associated Taxiway G has been open for use while resurfacing of the existing apron is in progress. The new apron will be used exclusively for the parking of medium and heavy scheduled air carriers until July 31st when the entire apron will be open for use. Light and medium turboprop aircraft will use the western portion of the existing apron, gaining access to this area via Taxiway B only. During this phase of work, Taxiway A will be closed. Figure 2 illustrates.

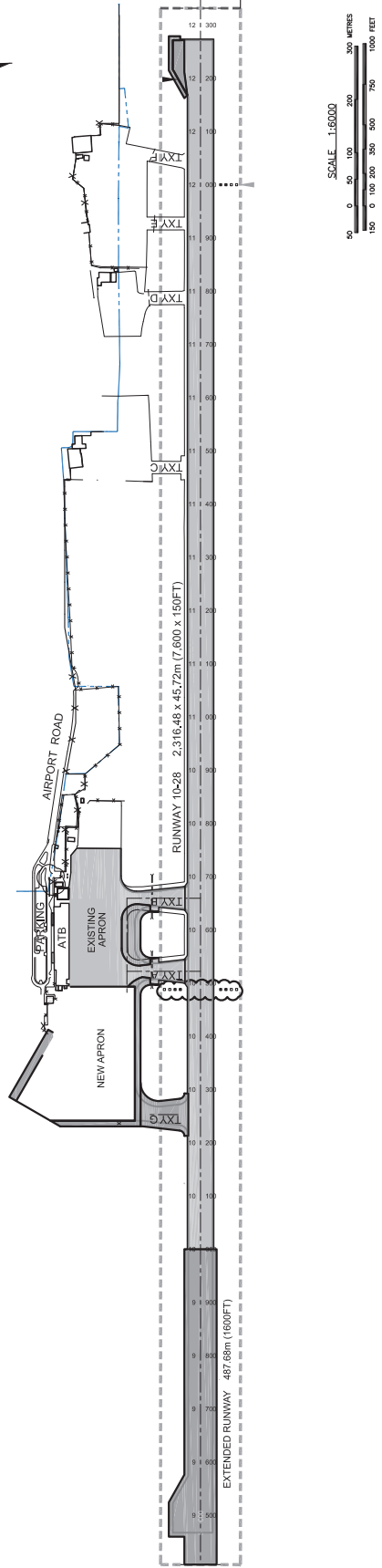
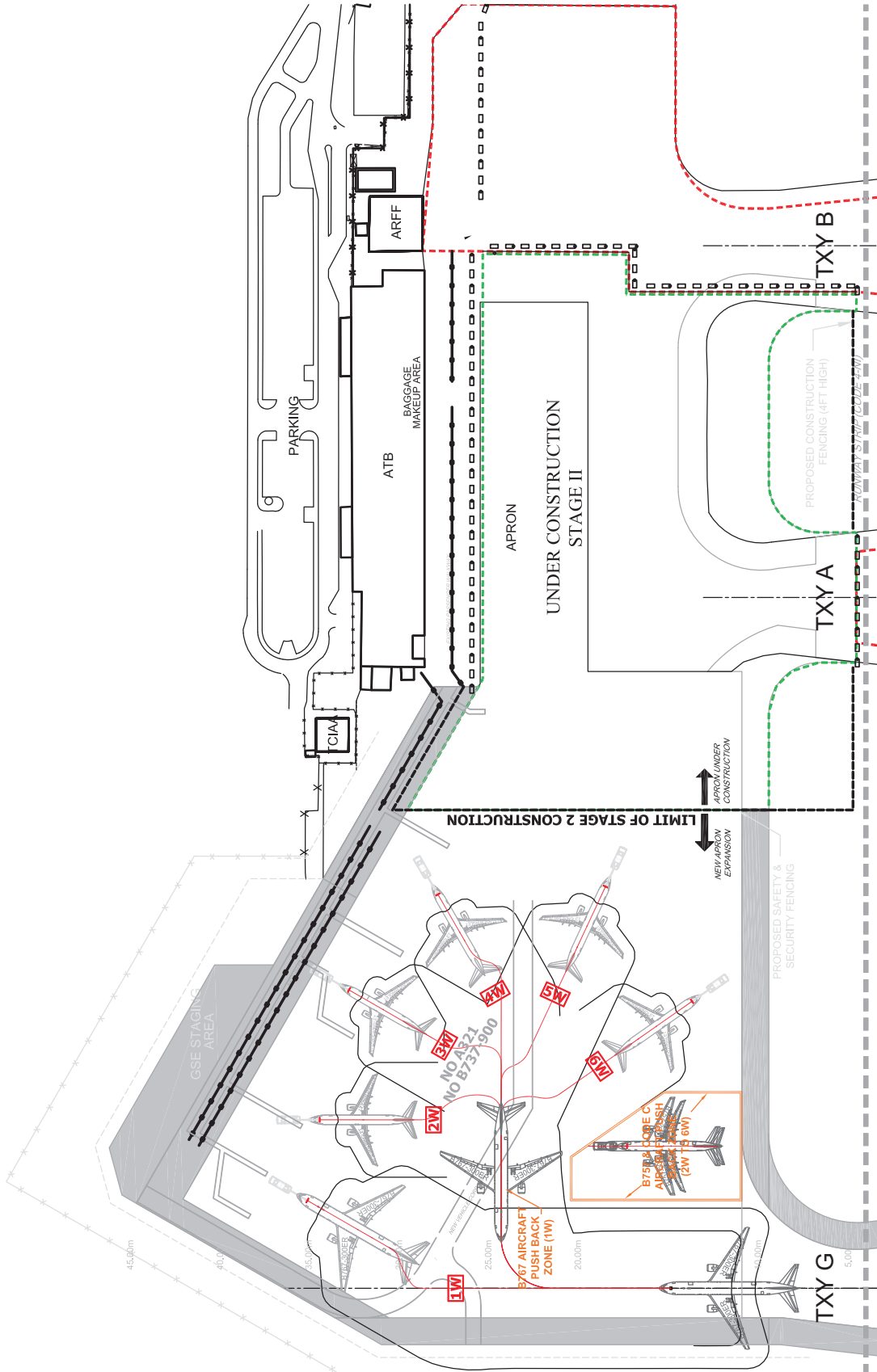

Figure 1 - Extended Runway



- LEGEND**
- TEMPORARY CONSTRUCTION / SECURITY FENCING
 - TEMPORARY LEACH-LINES
 - LOW PROFILE CONSTRUCTION BARRICADE
 - PROPOSED TEMPORARY PUSH BACK AREA
 - NEW PERIMETER FENCE
 - NIGHT TIME CONSTRUCTION AREA
 - DAY / NIGHT TIME CONSTRUCTION AREA
 - PROPOSED TEMPORARY LEACH-LINES
 - PROPOSED TEMPORARY PUSH BACK AREA
 - PROPOSED PERMANENT LINE MARKINGS

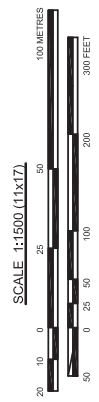

Figure 2 - New Apron and Taxiway